

( STATO ATTUALE )

# PIANO TERRA

(vano scala)

H= m. 4,00

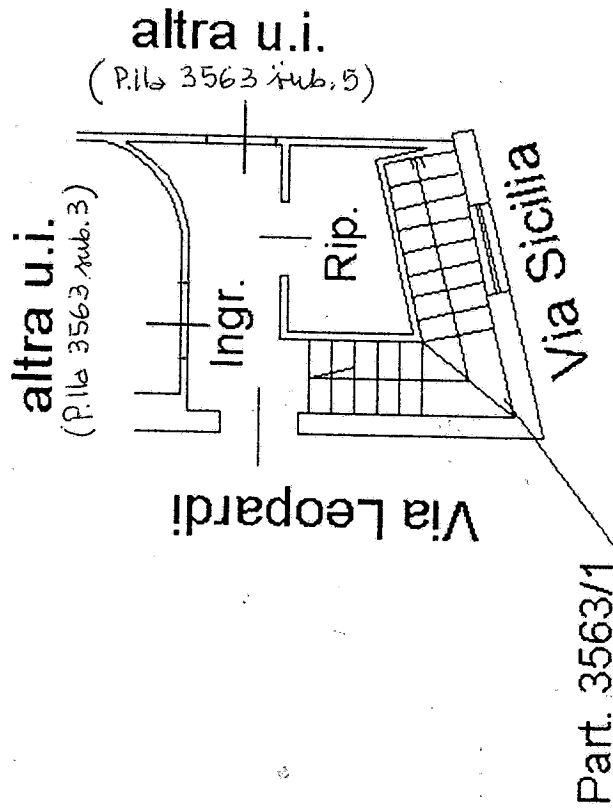

Scala 1/100



# PIANTA PIANO INTERRATO - STATO ATTUALE

(H = 2,96 m)

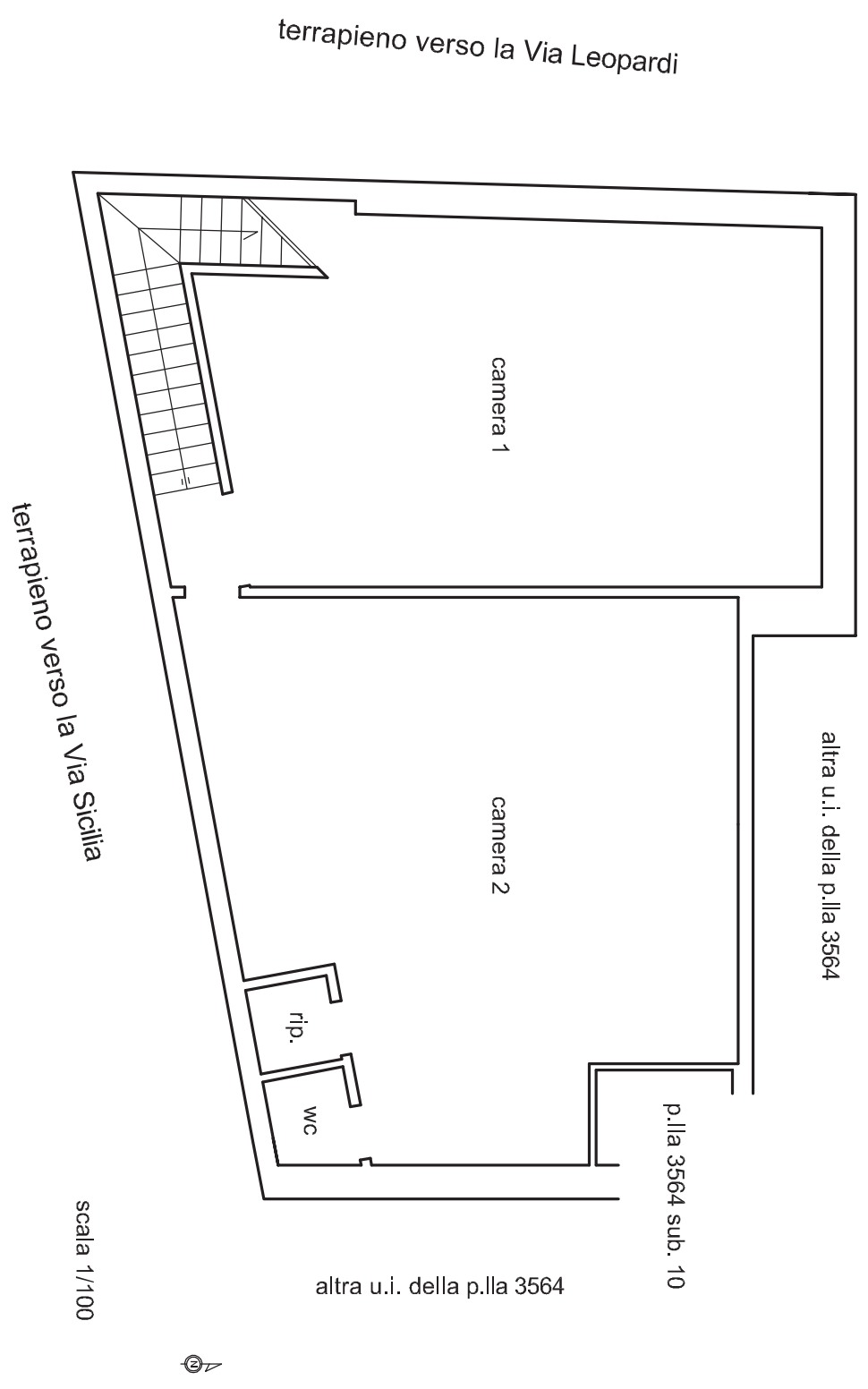

terrapieno verso la Via Leopardi

camera 1

camera 2

altra u.i. della p.lla 3564

terrapieno verso la Via Sicilia

ri.p.

WC

p.lla 3564 sub. 10

altra u.i. della p.lla 3564

scala 1/100

